

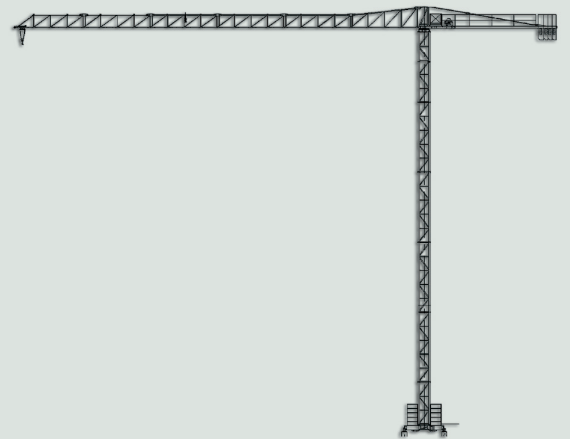

GRD 40

*Gru da città senza cuspidè
Top less city crane
City kran ohne turmspitze
City grue sans poinçon*



RD LIFT

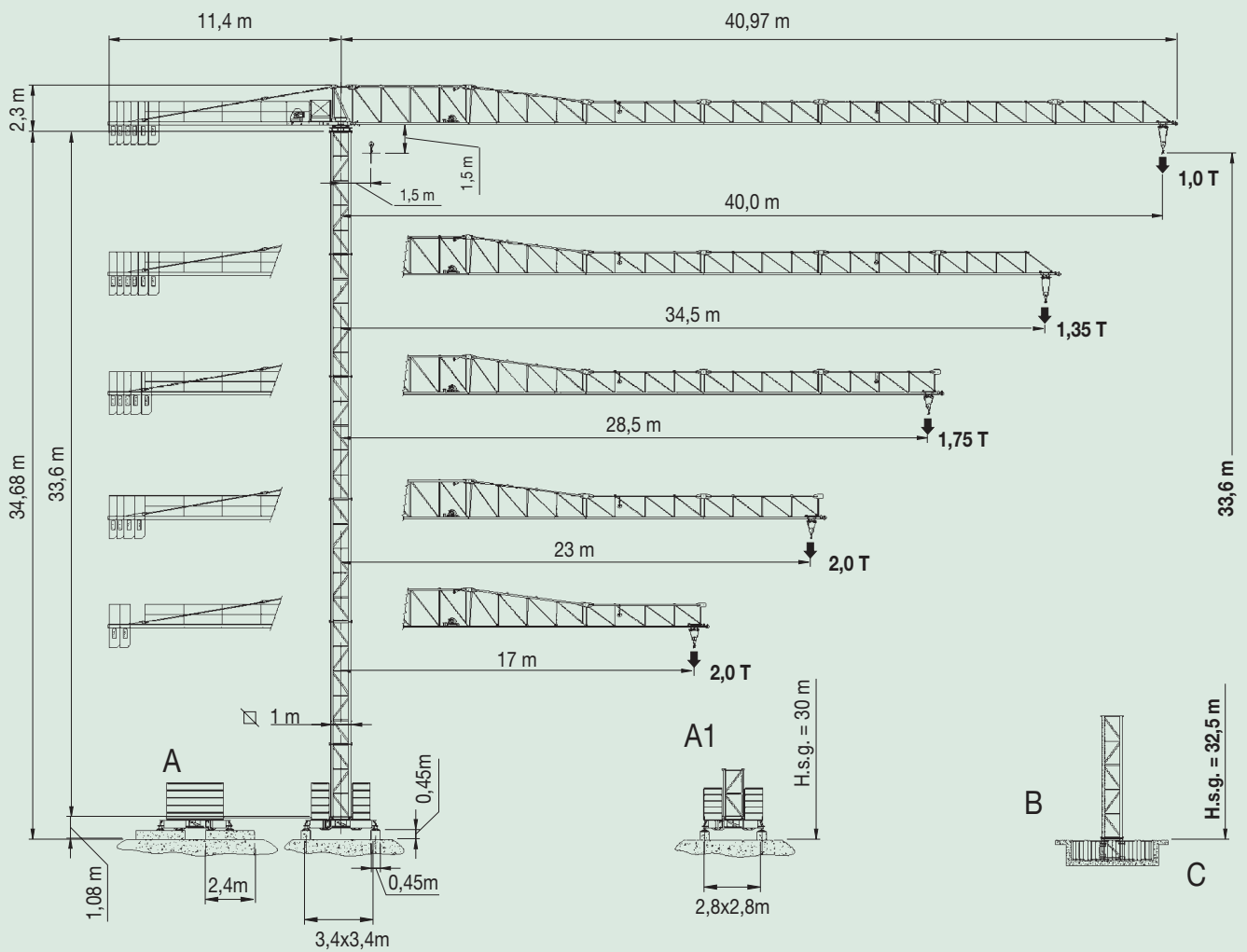

A

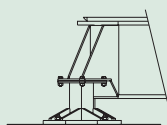

Stabilizzatore fisso

A1



Stabilizzatore regolabile

B

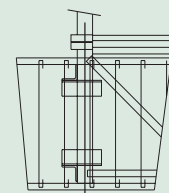

GRD 40

Gru da città senza cuspidi
 Top less city crane
 City kran ohne turmspitze
 City grue sans poinçon



A3 FEM1,001



Raggi e portate - Radius and s.w.l.

Portata max / Max s.w.l.		2000 kg.					3000 kg.				
Braccio / Jib (m.)		40	34	28	23	17	40	34	28	23	17
Campo di portata max Max s.w.l. range		21,29	23,89	25,18	23	17	14,85	16,55	17,36	15,84	17
Raggi (m.) Radius (m.)	15	2000	2000	2000	2000	2000	2968	3000	3000	3000	3000
	16	2000	2000	2000	2000	2000	2767	3000	3000	2968	3000
	17	2000	2000	2000	2000	2000	2591	2914	3000	2779	3000
	18	2000	2000	2000	2000		2435	2739	2885	2612	
	19	2000	2000	2000	2000		2295	2584	2722	2463	
	20	2000	2000	2000	2000		2170	2444	2575	2330	
	21	2000	2000	2000	2000		2058	2318	2442	2209	
	22	1930	2000	2000	2000		1955	2203	2322	2100	
	23	1839	2000	2000	2000		1862	2099	2212	2000	
	24	1756	1990	2000			1777	2004	2112		
	25	1680	1905	2000			1699	1916	2020		
	26	1610	1826	1932			1626	1835	1935		
	27	1545	1752	1855			1560	1761	1857		
	28	1485	1685	1784			1498	1692	1784		
	29	1429	1622				1440	1627			
	30	1377	1563				1387	1567			
	31	1328	1508				1337	1511			
	32	1282	1457				1290	1459			
	33	1239	1408				1246	1410			
	34	1199	1363				1204	1363			
35	1161					1165					
36	1125					1129					
37	1091					1094					
38	1059					1061					
39	1029					1030					
40	1000					1000					

Braccio e contrappeso - Jib and counterweight

Braccio / Jib (m.)	17	23	28.5	35	40
Contrappeso / Counterweight (t.)	2,384	4,012	4,826	5,640	5,640
	tipo/ type	Quantità / Quantity			
Composizione Composition	A 350 (814 Kg.)	-	2	3	4
	B 510 (1192 Kg.)	2	2	2	2

Altezza sottogancio, zavorra di base, reazioni - H.U.H., max base ballast, corner pressure

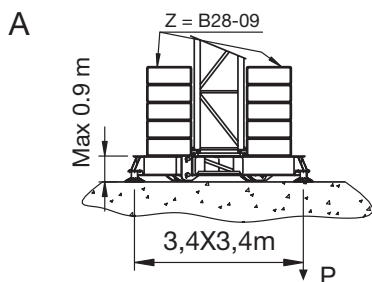

H (m.)	Z (t.)	P max (t.)
33,2	44	31
29,6	36	28
23,6	32	25
17,6	32	25
11,6	32	25

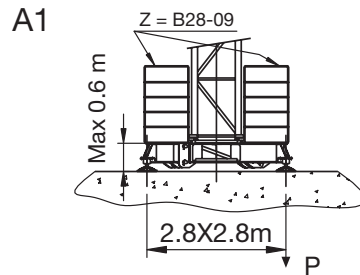

H (m.)	Z (t.)	P max (t.)
-	-	-
29,6	48	37
23,6	44	34
17,6	44	30
11,6	44	30

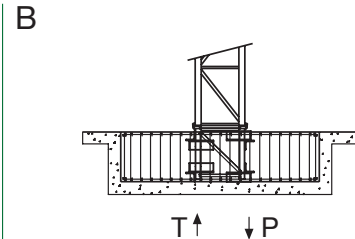

H (m.)	Z (t.)	P max (t.)
32,5	38,5	52,5
28,9	35,5	45,0
22,9	31,0	40,0
16,9	31,0	40,0
10,9	31,0	40,0

Caratteristiche azionamenti principali - General technical characteristics

Rotazione - Slewing	giri/min	Kw	cv	Carrello - Trolley	m/min	Kw	cv
	0,38	2,9	4		20	1,4	2
	0,71				40		
	1,02						

Argano - Hoisting winch	m/min	Kg	Kw	cv
	5,5	2000	8,8	12
	22	2000		
	44	1000		

Forza motrice totale - Total installed power

8,8 Kw (12Hp)

13,1 Kw

Lista dei pesi - Packing list

Pos. Item	Pezzi Pieces	Descrizione Description	Figura Draw	Dimensioni (m.) Dimensions			Peso (Kg) Weight		
				L	W	H	Unit.	Tot.	
1	1	Elemento di freccia Jib element	N°1	5,930	0,790	2,040		650	
	1		N°2	5,930	0,790	1,930		597	
	1		N°3	5,985	0,790	1,190		354	
	1		N°4	11,860	0,790	1,190		321	
	1		N°5	6,020	0,790	1,190		297	
	1		N°6	1,700	0,790	1,190		263	
	1		N°7	1,700	0,790	1,190		238	
2	1	Controfreccia girevole, argano sollevamento, quadro elettrico, cuspidi. Counterjib tournable, hoisting winch, trolley jib, electrical bx, a frame.		3,750	1,705	2,300		1925	
	1	Elemento controfreccia esterno. External counterjib.		9,100	0,875	1,230		795	
3	4	Blocchi di contrappeso. Counterweight block.		A350	0,600	0,350	2,145	814	3256
	2			B510	0,600	0,510	2,145	1192	2384
4	1	Elemento di torre Tower element		6,000	1,110	1,110		985	
				3,600	1,110	1,110		595	
5	1	Tronchetto di fondazione Expendable foundation element		1,075	1,110	1,110		334	
6	1	Trave principale di base. Base main beam.		TP (2,8x2,8 m)	4,160	2,400	0,605	-	1083
				TP (3,4x3,4 m)	5,010	2,400	0,605	-	1154
	2	Semitrave di base. Half base beam.		TP (2,8x2,8 m)	1,150	0,300	0,490	172	344
				TP (3,4x3,4 m)	1,575	0,300	0,490	225	450
7	24	Blocco di zavorra Base ballast block (B28-09)		(2,8x2,8 m)	2,800	0,360	0,900	2000	48000
	22			(3,4x3,4 m)	2,800	0,360	0,900	2000	44000

Sequenza di montaggio - Assembling sequence

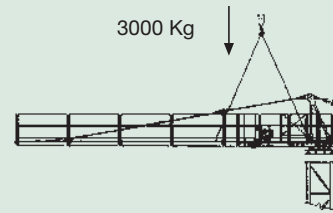
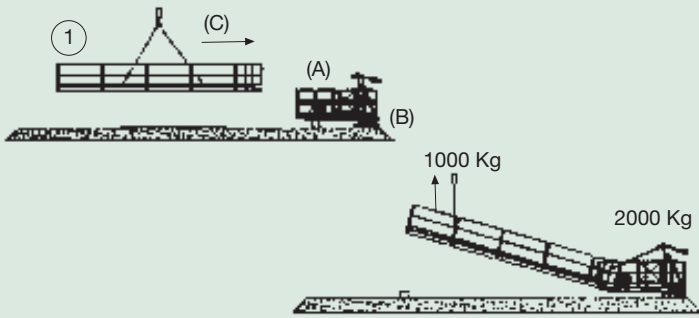
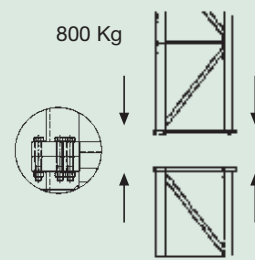
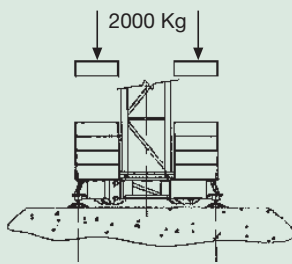
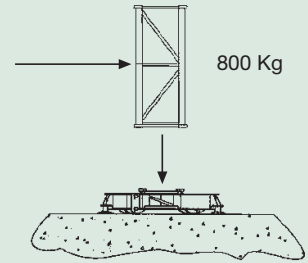
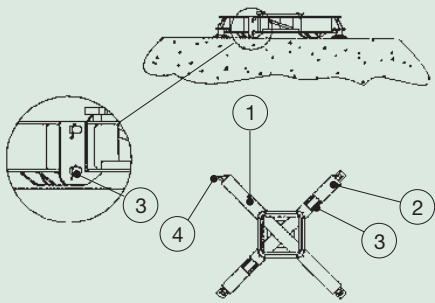



Gru da città senza cuspid
Top less city crane
City kran ohne turmspitze
City grue sans poincon

Dati illustrativi non impegnativi
con riserva di modifica senza
preavviso.

Specifications and data not
binding subject to modification without
notice.

Angaben und Beschreibung
unverbindlich andreungen
vorbehalten ohne weitere mitteilung.

Données techniques seulement
indicatives modifications réservées
sans préavis

RDLIFT

RDLIFT srl

Via Emilia San Pietro, 25

42100 Reggio Emilia – Italy

Tel. +39 0522 448511 - Fax +39 0522 448540

commerciale@rdlift.com

www.rdlift.com

Agente - Dealer